

Belt Clip Assembly Instructions

West Marine VHF 50(A) and 55 Hand Held VHF Radio
Models 7886468 & 7642358

1. Attaching the Belt Clip

- Screw the clip mount into the back of the radio, ensuring the plastic-molded raised “key” on the mount aligns with the indented “key” on the back of the radio. (Fig. 1)
- When properly positioned, the beveled portion on the front of the clip mount faces toward the top of the radio. (Fig. 2)
- Slide the belt clip onto the clip mount until it clicks.

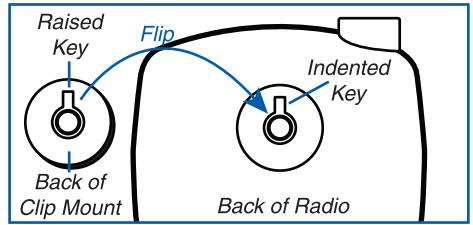

Fig. 1: Attach Clip Mount

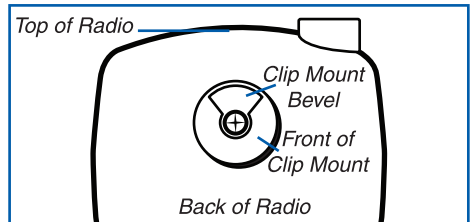

Fig. 2: Clip Mount Properly Positioned

2. Removing the Belt Clip

- Rotate the belt clip 180° so that the jaws of the clip face toward the top of the radio. (Fig. 3)
- Push the clip up and off.

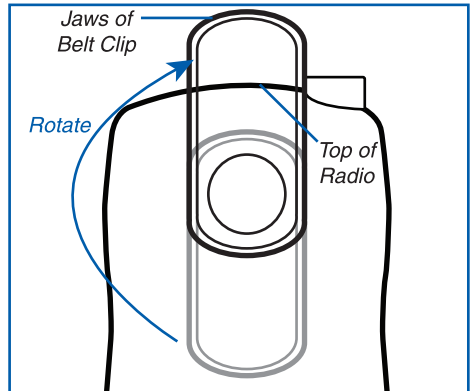
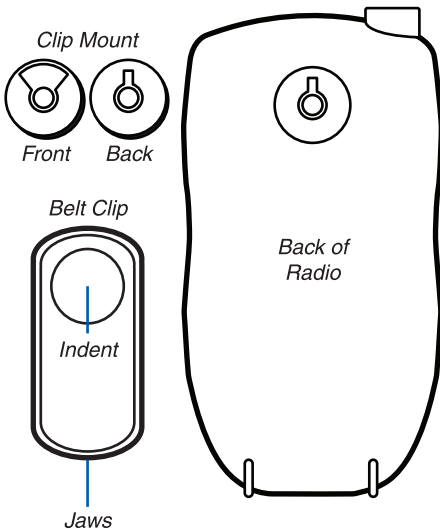

Fig. 3: Rotate Belt Clip 180°